

2016 SUBRA FAMILY REUNION - AUGUST 6 - 11:30 AM
 IRONWOOD SPRINGS CHRISTIAN RANCH
 EXIT #205 NEAR STEWARTVILLE ON I-90

This year, we gather at a delightful Christian campground. We will be in "the old barn" building to eat, but anyone can also eat right next to it under cover but in outside air. So wear your jeans and kick back.

We will provide Three Bean Hotdish and:

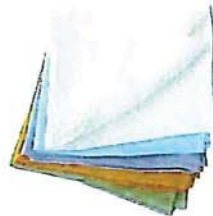

What you can bring:

Sidedish, dessert, etc.



Your drink of choice



Please keep in mind that there are no refrigerators available when bringing your sidedish, dip, or dessert.

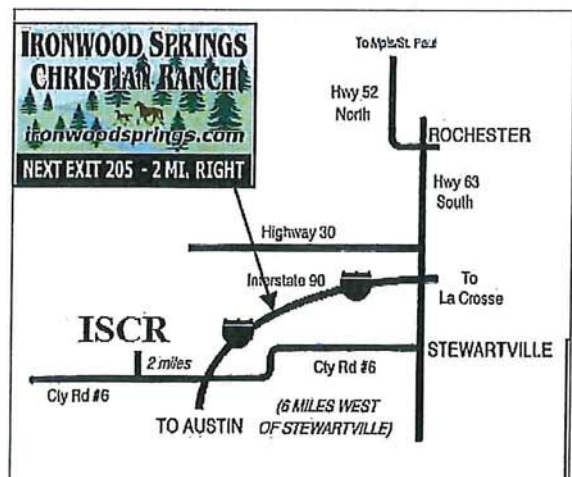

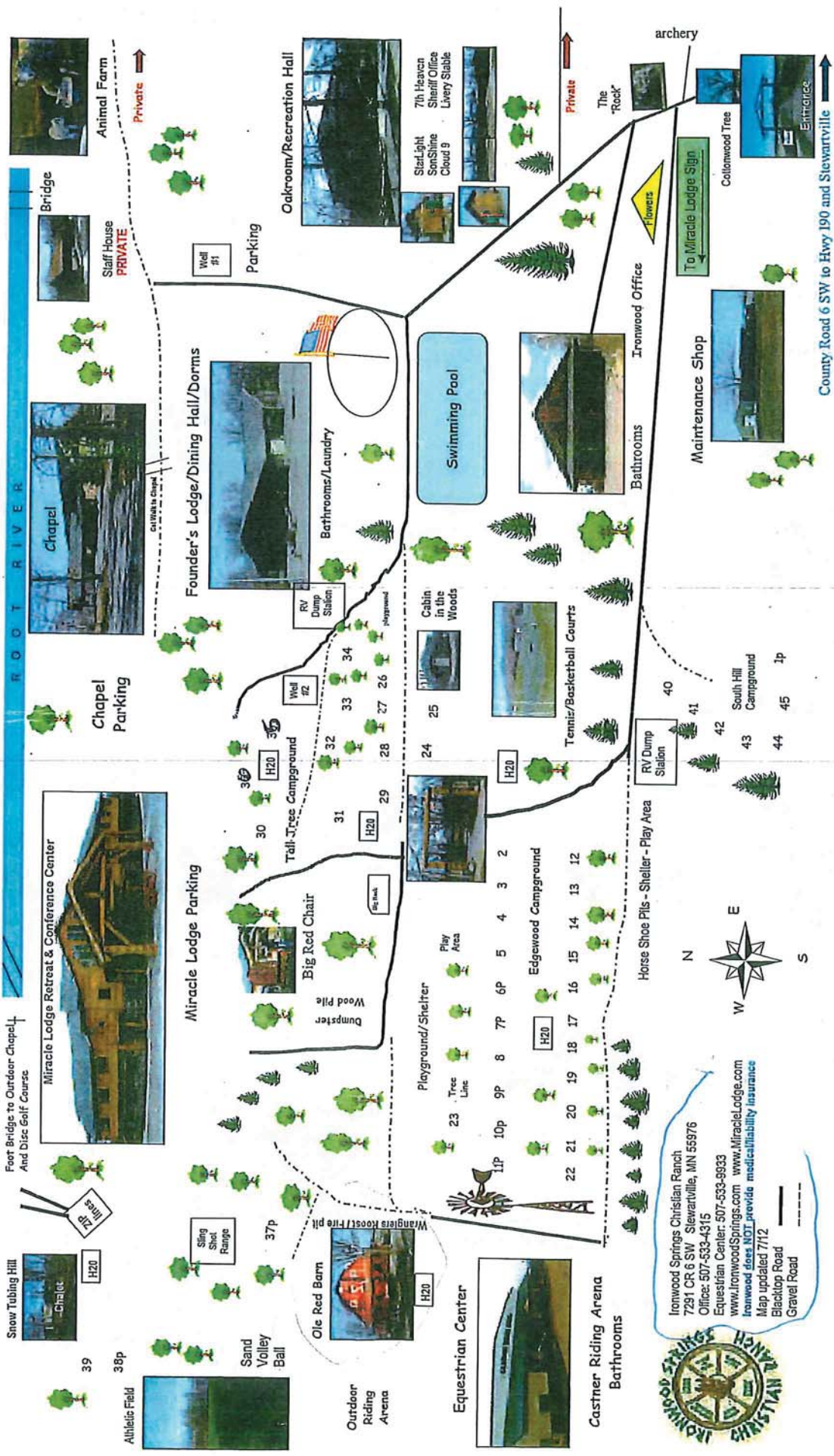

Foot Bridge to Outdoor Chapel
And Disc Golf Course

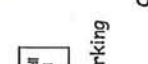
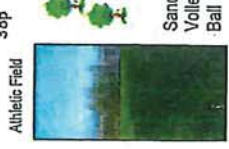

Ironwood Springs Christian Ranch
7291 OR 6 SW Stewartville, MN 55976
Office: 507-533-4315
Equestrian Center: 507-533-9933
www.IronwoodSprings.com www.MiracleLodge.com
Ironwood does NOT provide medical/liability insurance
Map updated 7/12
Blacktop Road
Gravel Road



County Road 6 SW to Hwy 190 and Stewartville



MAKE A DONATION

(507) 533-4315 | DIRECTIONS

youth

MILITARY

PHYSICALLY
CHALLENGED

Horses

Get to know yourself, others, and God better!



Eat inside or

outside under cover

You are at the
right place if
you drive past
the 5-trunk tree!



Check out the camel!

Be sure to call 507-533-4315
to sign up for
any activities
NO LATER THAN
JULY 23, 2016!

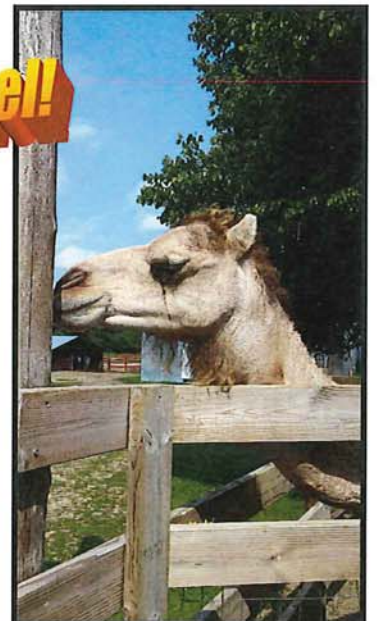

2015 Rates - Ironwood Springs Christian Ranch, Inc

Dorm & Cabin Retreat Rates – March through Nov

Per person	
\$90	includes 1 night lodging, 2 meals, meeting room
\$105	includes 2 nights lodging, 4 meals, meeting room
\$70	includes 2 nights lodging, meeting room

**OFFICE PHONE NUMBER:
507 - 533 - 4315**

Dorm & Cabin Retreat Rates – December through February

Per person	
\$115	includes 1 nights lodging, 2 meals, meeting room and 1- 2hr snow tubing session
\$130	includes 2 nights lodging, 4 meals, meeting room and 1- 2hr snow tubing session
\$90	includes 2 nights lodging, meeting room

Miracle Lodge Retreat Rates*

Adult Retreat Rates	1 night, 2 meals, mtg room		2 nights, 4 meals, mtg room		3 nights, 6 meals, mtg room	
	Weekend	Weekday	Weekend	Weekday	Weekend	Weekday
Triple Occupancy	\$135	\$110	\$150	\$125	\$200	\$175
Double occupancy	\$160	\$135	\$170	\$145	\$225	\$200
Single occupancy	\$not available	\$170	\$not available	\$185	\$not available	\$240

Adult Retreat Rates (no meals)	1 night, mtg room	2 nights, mtg room	3 nights, mtg room
Triple Occupancy	\$100	\$120	\$145
Double occupancy	\$120	\$135	\$160

Family Reunion Retreat rates**	1 night, 2 meals, mtg room	2 nights, 4 meals, mtg room	3 nights, 5 meals, mtg room
Adults	\$120	\$140	\$175
Children 4-10	\$65	\$75	\$85
Children 0-3	no charge	no charge	no charge

* rates do not include snow tubing sessions, meeting room will be determined by ISCR, linens are provided, Includes free one-hour tractor-drawn wagon ride weather permitting.

** assumes two or more people per room. Charge for single adults is \$215 for 3 overnights, \$200 for 2 overnights, \$185 for 1 overnight.

		Weekend	Weekday	
Family Room Rate	Up to 5 people	\$110	\$90	
Family Suites	up to 7 people	\$135	\$115	
Fireplace Suite	up to 5 people	\$150	\$125	Includes deck, sitting room, electric fireplace
Miracle Lodge weekly rates: 5 days – discount 5%, 7 days – discount 10%				

Facilities	Weekdays	Weekends	
Founder's Lodge	\$225	\$275	up to 6 hours (\$25 each additional hour)
Lodge & Dining Hall	\$325	\$425	up to 6 hours (\$25 each additional hour)
Chapel	\$400-\$1000	\$1500-\$2000	
Oakroom	\$175	\$175	up to 6 hours (\$25 each additional hour)
Wall's Room	\$175	\$175	up to 6 hours (\$25 each additional hour)
Bunk Houses \$10pp, min price is:	\$70	\$80	per night (no bathroom in cabins)
Cabin in the Woods	\$75	\$85	per night (small frig and micro wave)
SonShine	\$95	\$110	per night A-Frame NO bathroom (small frig and micro wave)
Starlight	\$100	\$135	per night A-Frame with bathroom (small frig and micro wave)
Recreation Center	\$200	\$200	per day
Rustic Chalet/Wranglers Roost	\$50	\$50	plus \$3 per person for up to 2 hours
Ole' Red Barn (seasonal)	\$200	\$225	up to 6 hours (\$25 each additional hour)

Cabin \$80
Lodge 110

have meals etc

Equestrian (Make all reservations in advance by calling 507-533-9933)

Wagon/Sleigh Ride	\$125	\$150 after 5pm or on Sunday	20 people
Cutter Ride	\$75		2 people
Trail Rides	\$20	per person for 1 hour - including instruction time	
Private Riding Lessons	\$140 for 4 lessons, \$40 for 1 lesson		
Group Riding Lessons	\$120 for 4 lessons, \$30 for 1 lesson		
Pony Rides	\$5	per person, children under 8 years of age	

Activities

Tractor-drawn Wagon Ride	\$60	\$80 after 5pm or on Sunday
Campground site	\$35 per site for up to 4 people, \$40 per site for up to 6 people, add'l \$5 per day for air conditioning	
Campground permanent	\$725 Edgewood/Tall Trees, \$825 South Hill w/ full hook-ups, \$200 winter storage	
Snow Tubing	\$12 per person includes 2 hr snow tubing/towrope/chalet. We provide hot water. Bring your own snacks and hot choc mix and cups.	
Pool	\$5 per person (non campers)	
Bouldering Wall, Archery, Challenge Course and Sling Shots	\$5 per person per event for one hour (rotation for large groups- minimum of 10 people per rotation)	
Zip Line	\$100 per hour (approx 35 rides), or \$5 per person with a minimum of 15 people	

Meals*

Breakfast - \$8	Lunch - \$9	Dinner - \$11	Chuck wagon meal - \$16	Snack - \$3 per person and up
-----------------	-------------	---------------	-------------------------	-------------------------------

Groups must rely on their own health/liability insurance. Prices and services are subject to change without notice.

7291 County Road 6 SW * Stewartville, MN 55976

* www.ironwoodsprings.com * www.miracelodge.com * Office 507-533-4315 * Fax 533-8126 * Stables 533-9933 *

ISCR is a non-profit, non-denominational youth camp in southern Minnesota, founded in 1976